

6500 In-Line Unstable Detonation Flame Arrester

Mainly used in long pipe sections or pipe sections with many elbows to arrest stable (optional 6400) and unstable detonations (optional 6500). In addition, this series of flame arresters can also arrest confined and unconfined, low-pressure and high-pressure deflagrations.

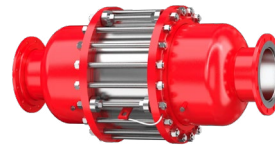

■ Features/

- Maximum flow, small pressure drop
- Easy to clean, not easy to clog, less maintenance
- Standard temperature detection port
- Bidirectional structure
- Easy to install, removable fire barrier for easy inspection and maintenance
- Support ANSI, DIN and HG/T20592~20635-2009 flanges

■ Specifications/

Model	Size	Gas Group (IEC/NEC)
6500 In-Line Unstable Detonation Flame Arrester	1"(DN25) ~ 40"(DN 1000)	II A/D II B3/C II C/B

■ Materials/

Model	Case	Fire barrier
6500 In-Line Unstable Detonation Flame Arrester	carbon steel 304 316L Hastelloy alloy	304 316L Hastelloy alloy

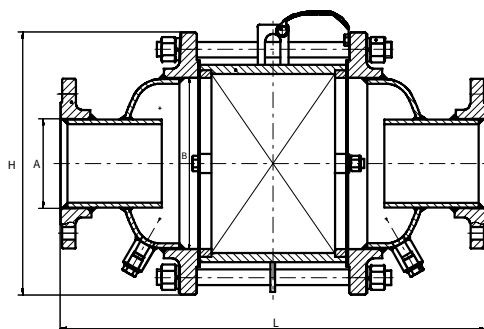

■ **Key parameter table/**

Model	A Size In(mm)	B Case Size mm	H Outer Diameter mm	L Length mm
6500	2(50)	100	220	460
	3(80)	150	285	500
	4(100)	200	340	550
	6(150)	300	460	980
	8(200)	400	580	1160
	10(250)	500	715	1350
	12(300)	600	868	1612

*The allowable tolerance is $\pm 1.00''(25\text{mm})$; the parameters are for reference only, please contact us for more information.